

Google Maps Aeraland Recreation Area



Imagery ©2020 Maxar Technologies, State of Ohio / OSIP, USDA Farm Service Agency, Map data ©2020 100 ft

Litzenberg Memorial Woods

TR 93

of U.S. 224 are closed to hiking and riding during hunting season. Please stay on marked trails. For your safety, please stay on marked trails.

Land
and
park
Residence

Historic Kinnis House Homestead

Activity Barn



Park Amen

Oakwoods Nature Preserve



Riverbend Recreation Area



- ### Park Amenities
- Picnic shelters
 - Fishing piers
 - K-9 Field of Dreams Dog Park
 - Sand volleyball courts
 - Playgrounds
 - Gazebo
 - Restrooms
 - Parking
 - Grass Parking for Horse Trailers

- ### Trails
- Loop Trail 1.2 miles
 - Heritage Trail 1 mile
 - Meadow Trail 4 mile
 - Woodland Trail 7 mile
 - River Trail 3 mile
 - Bridle Trail 1.94 miles



- Forest Land
- Grassland
- Bridge

Disc Golf Course
Trail starts at Big Oaks Activity Area Parking Lot

Cross-Country Skiing
All trails may be used for skiing

Activity Area paths are paved.

To Reservoirs

Google Maps Riverside Blanchard River Greenway Trail



Imagery ©2020 Maxar Technologies, State of Ohio / OSIP, USDA Farm Service Agency, Map data ©2020 100 ft



Benton Ridge Park



OHIO DEPARTMENT OF NATURAL RESOURCES
DIVISION OF WILDLIFE

FINDLAY RESERVOIRS 1 AND 2

HANCOCK COUNTY

Reservoir 1 - 187 acres of fishing water
Reservoir 2 - 440 acres of fishing water
7.5 miles of shoreline

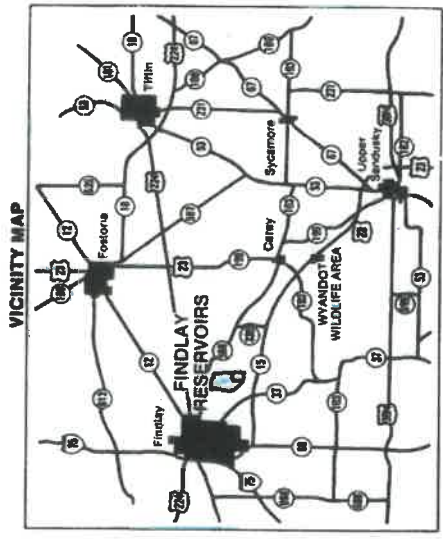
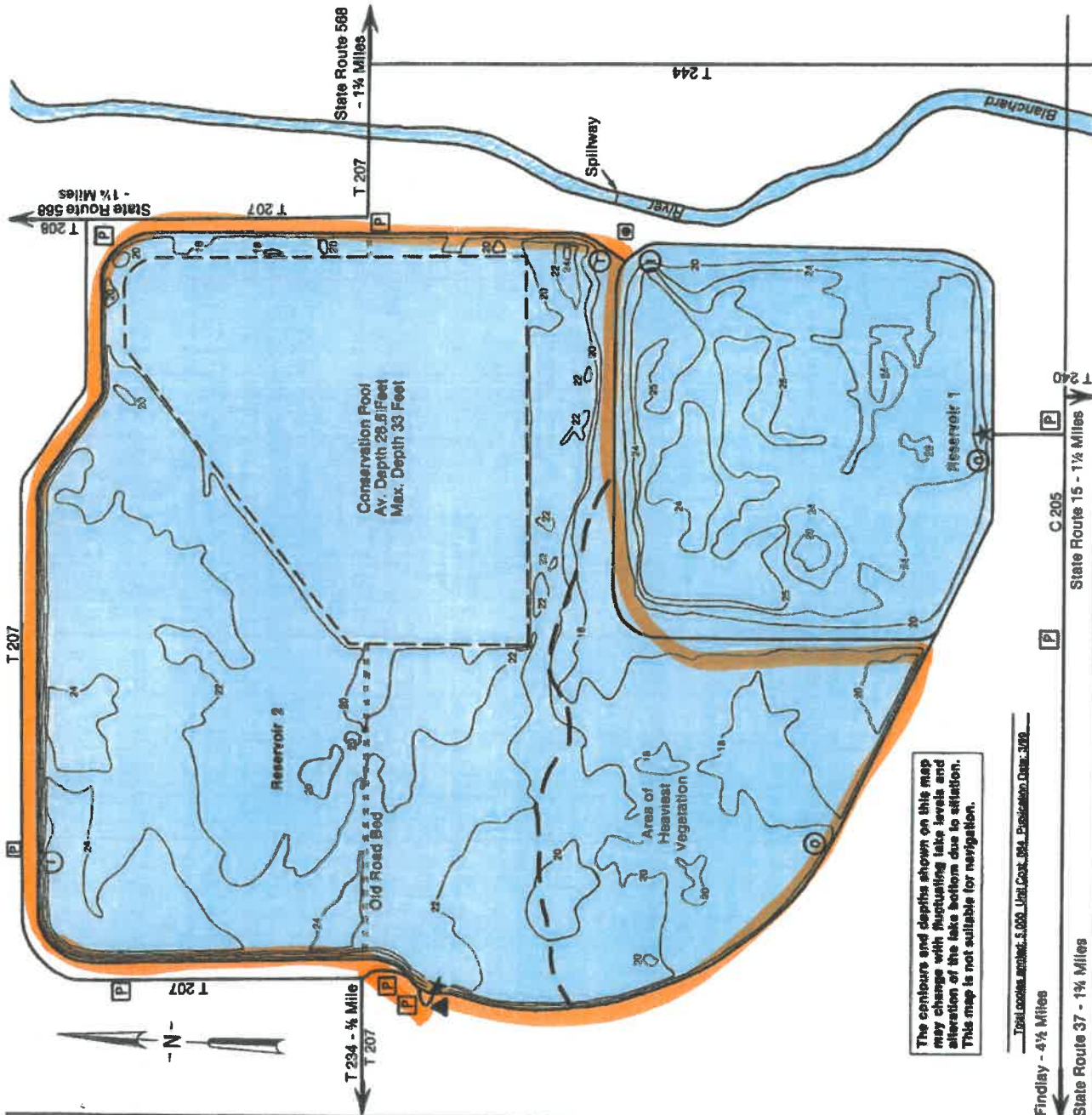

LEGEND

Parking	★
Boat Ramp	▲
Latrine	□
Pump House	①
Inlet	②
Outlet	③



The contours and depths shown on this map may change with fluctuating lake levels and siltation of the lake bottom due to effluent. This map is not suitable for navigation.

Total cost: \$1,000. Unit Cost: \$84. Production Date: 3/80.

Findlay - 4 1/4 Miles

State Route 37 - 1 1/4 Miles

①

②

③

④

⑤

⑥

⑦

⑧

⑨

⑩

⑪

⑫

⑬

⑭

⑮

⑯

⑰

⑱

⑲

⑳

㉑

㉒

㉓

㉔

㉕

㉖

㉗

㉘

㉙

㉚

㉛

㉜

㉝

㉞

㉟

㊱

㊲

㊳

㊴

㊵

㊶

㊷

㊸

㊹

㊺

㊻

㊼

㊽

㊾

㊿

0

1

2

3

4

5

6

7

8

9

10

11

12

13

14

15

16

17

18

19

20

21

22

23

24

25

26

27

28

29

30

31

32

33

34

35

36

37

38

39

40

41

42

43

44

45

46

47

48

49

50

51

52

53

54

55

56

57

58

59

60

61

62

63

64

65

66

67

68

69

70

71

72

73

74

75

76

77

78

79

80

81

82

83

84

85

86

87

88

89

90

91

92

93

94

95

96

97

98

99

100

101

102

103

104

105

106

107

108

109

110

111

112

113

114

115

116

117

118

119

120

121

122

123

124

125

126

127

128

129

130

131

132

133

134

135

136

137

138

139

140

141

142

143

144

145

146

147

148

149

150

151

152

153

154

155

156

157

158

159

160

161

162

163

164

165

166

167

168

169

170

171

172

173

174

175

176

177

178

179

180

181

182

183

184

185

186

187

188

189

190

191

192

193

194

195

196

197

198

199

200

201

202

203

204

205

206

207

208

209

210

211

212

213

214

215

216

217

218

219

220

221

222

223

224

225

226

227

228

229

230

231

232

233

234

235

236

237

238

239

240

241

242

243

244

245

246

247

248

249

250

251

252

253

254

255

256

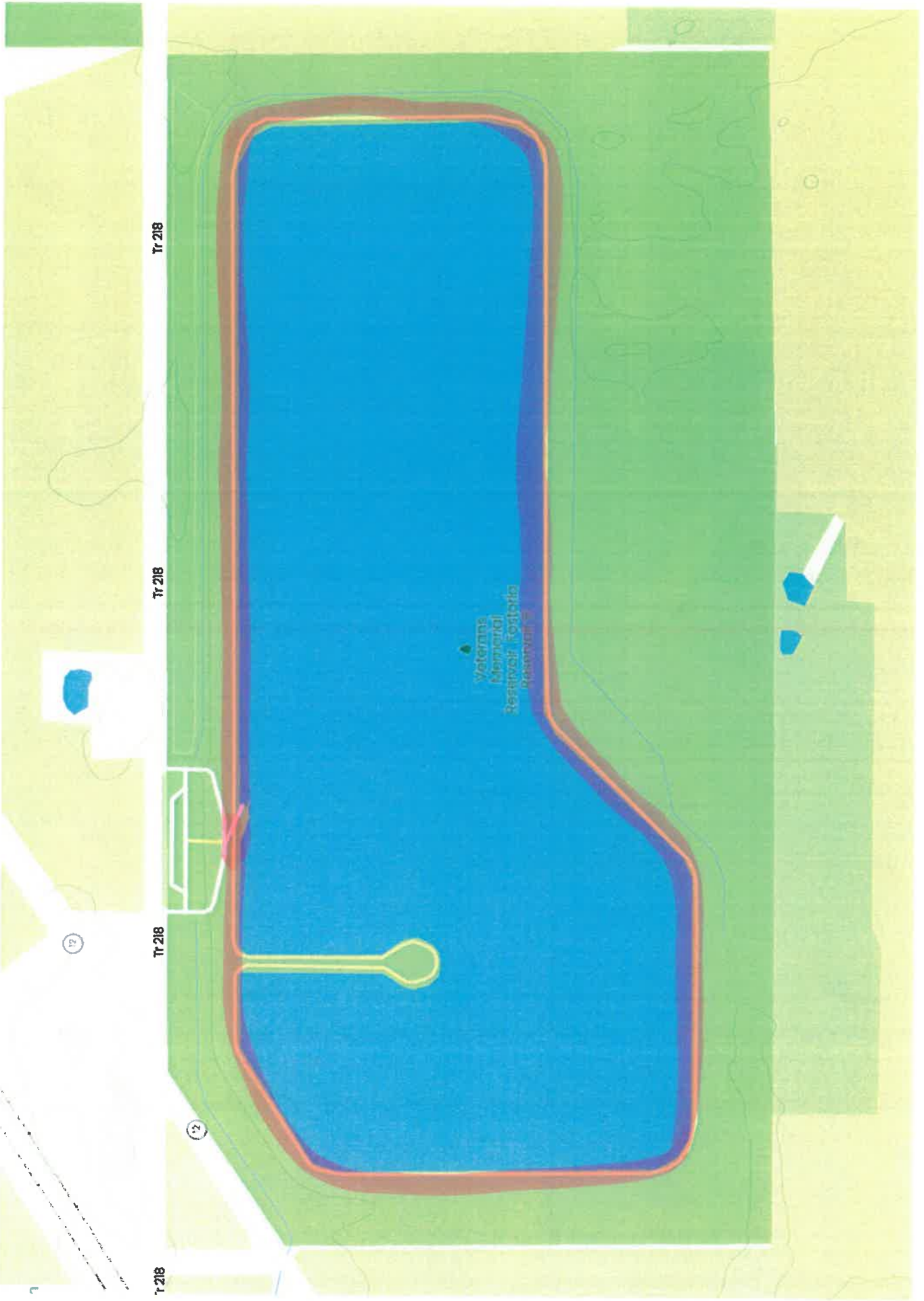

Tr 218

Tr 218

Tr 218

Tr 218

Veterans
Memorial
Reservoir
Colorado

12

13



03 1007 14

03 1007 14

03 1007 14



McComb Reservoirs 1 & 2

Hancock County



Reservoir 1: 6 Acres of Water and 0.40 Miles of Shoreline
Reservoir 2: 20 Acres of Water and 0.70 Miles of Shoreline

Contours and depths shown on this map may change with fluctuating lake levels and character of the lake bottom. This map is not suitable for navigation.

Map prepared with graphics using latitude and longitude.

Contour intervals are in 5 ft increments for McComb #1 and 5 ft increments for McComb #2. Reservoir last surveyed: 2013

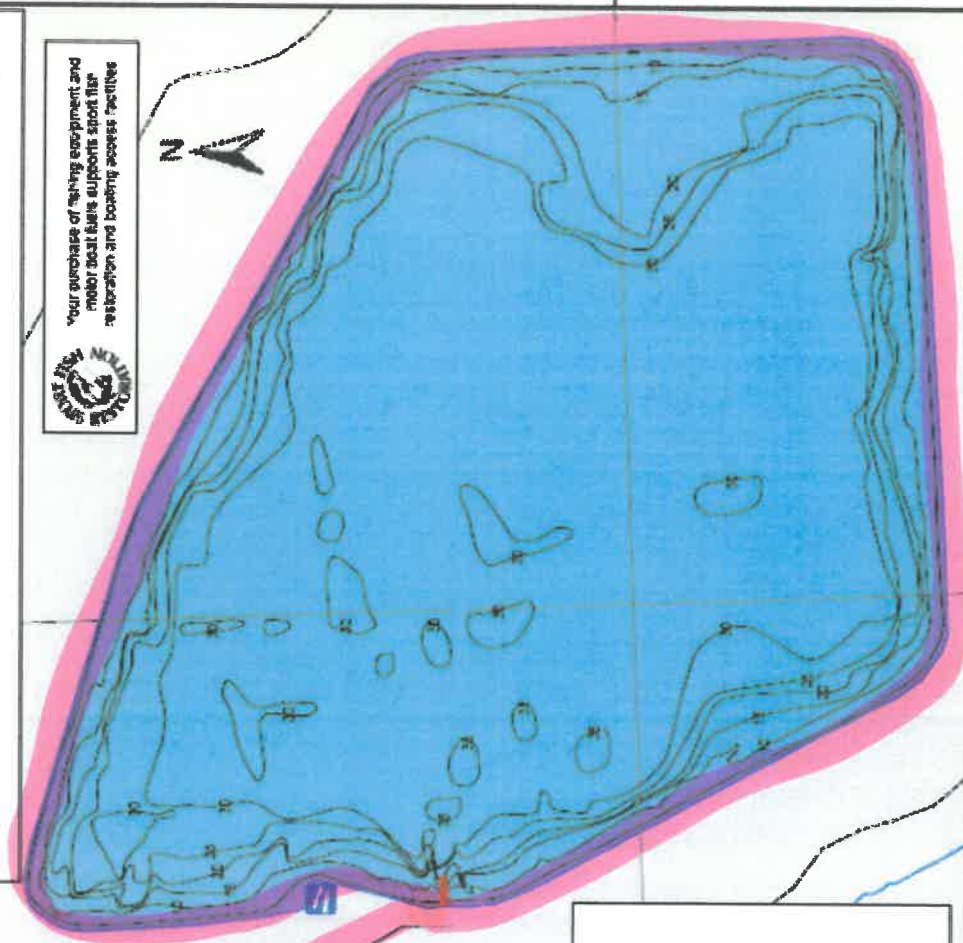

Facilities	Legend
Parking	Outlet Structure
Boat ramp	Paved Path
Restrooms	Roads
	State Route
	County, Township, and Park



03 1007 14

03 1007 14

03 1007 14

03 1007 14